

T-128-129-N

# WHITE ROCK 'W' PLAT

R-47-48-W

(L.A. downers)

RICHLAND CO., ND

R48W | R47W

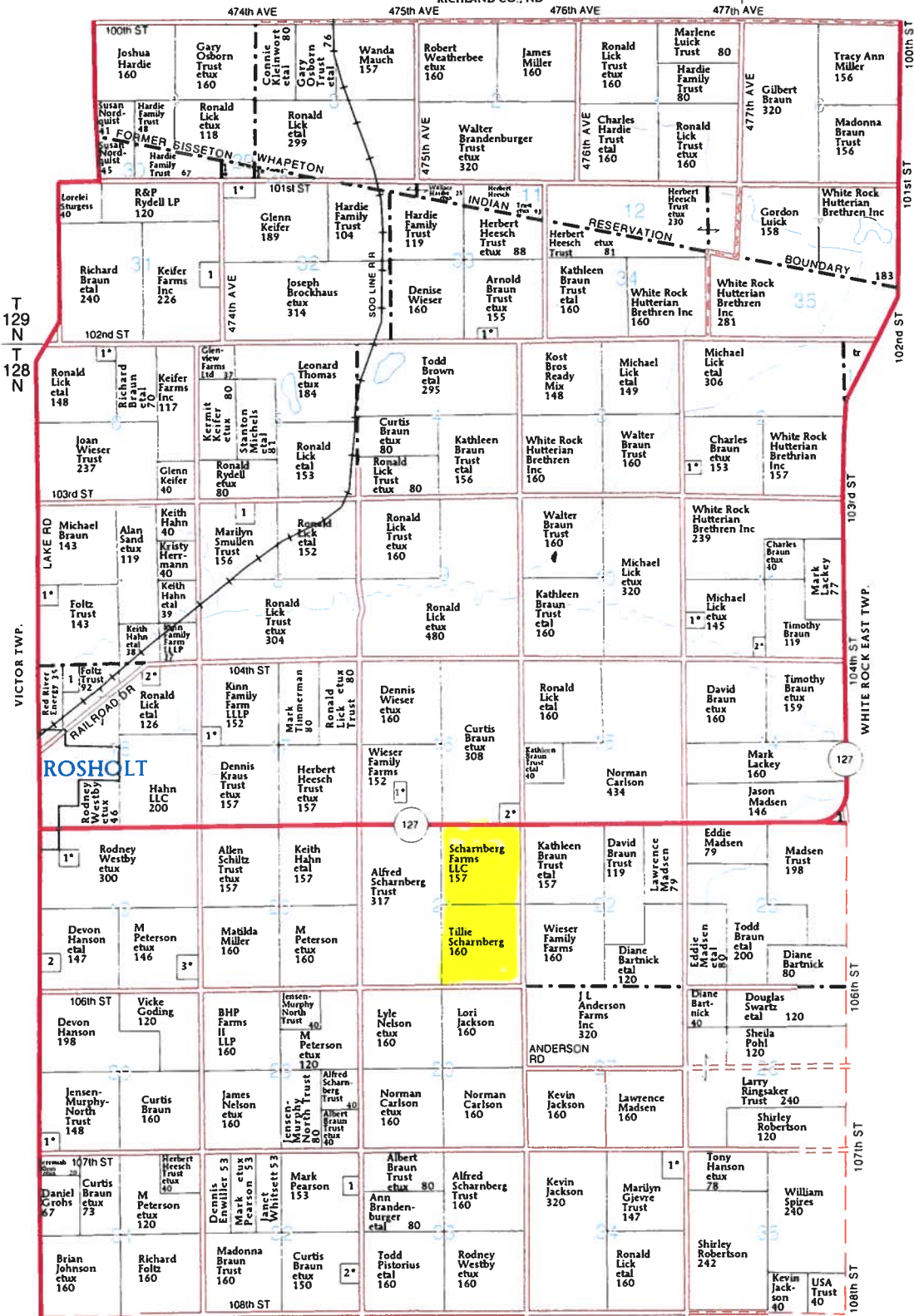

### WHITE ROCK 'W' TOWNSHIP SECTION 2S

- SECTION 2S  
1. Braun, Loran etux 7
- SECTION 6S  
1. Brandell, Jason etux 7
- SECTION 7S  
1. Foltz, Raymond etux 14
- SECTION 8  
1. Lick, Ronald J 12

### SECTION 11S

- 1. Braun, Charles etux 10
- 2. Guy, James etux 5

### SECTION 14

- 1. State of South Dakota 7

### SECTION 16

- 1. Wieser, Gregory etux 6
- 2. Wieser, Ralph etux 10

### SECTION 17

- 1. Braun, William etux 8

### SECTION 18

- 1. Town of Rosholt 16
- 2. Laurence, Dustin etux 11

### SECTION 19

- 1. Westby, Benjamin etux 12
- 2. Hanson, Devon 11

### SECTION 28N

- 3. Ceroll, Larry etux 14

### SECTION 29N

- 1. Lick, Ronald etux 23

### SECTION 30S

- 1. Roeder, Jon etux 11

### SECTION 31N

- 1. Laurence, Derek 14

### SECTION 32N

- 1. Braun, Chad etux 11

### SECTION 32S

- 1. Swedish Evangelical Lutheran St Joseph Church 7

### SECTION 33N

- 2. Akerson, Kirk etux 10
- 1. Laurence, Steven etux 5

### SECTION 34S

- 1. VerGeidt, Tom etux 13