

Aerial Map



map center: 45° 51' 23.05, -96° 40' 41

0ft 840ft 1680ft

Maps Provided By:

CUSTOMIZED ONLINE MAPPING
© AgriData, Inc. 2018 www.AgriDataInc.com

21-128N-48W
Roberts County
South Dakota



6/1/2018

Field borders provided by Farm Service Agency as of 5/21/2008.

TRACT 2

South Dakota
Roberts

U.S. Department of Agriculture
Farm Service Agency
Abbreviated 156 Farm Record

FARM: 9669
Prepared: 5/31/18 9:34 AM
Crop Year: 2018
Page: 1 of 2

Report ID: FSA-156EZ

DISCLAIMER: This is data extracted from the web farm database. Because of potential messaging failures in MIDAS, this data is not guaranteed to be an accurate and complete representation of data contained in the MIDAS system, which is the system of record for Farm Records.

Operator Name: _____ Farm Identifier: _____ Recon Number: _____
Split 7788 into 9669-9670

Farms Associated with Operator:
9670

CRP Contract Number(s): None

Farmland	Cropland	DCP Cropland	WBP	WRP/EWP	CRP Cropland	GRP	Farm Status	Number of Tracts
316.74	306.1	306.1	0.0	0.0	0.0	0.0	Active	3
State Conservation	Other Conservation	Effective DCP Cropland	Double Cropped	MPL/FPW	Native Sod			
0.0	0.0	306.1	0.0	0.0	0.0			

ARC/PLC

ARC-IC NONE ARC-CO CORN , SOYBN PLC NONE PLC-Default NONE

Crop	Base Acreage	CTAP Tran Yield	PLC Yield	CCC-505 CRP Reduction
CORN	147.37		158	0.0
SOYBEANS	139.63		45	0.0
Total Base Acres:	287.0			

Tract Number: 4416 Description: N19A SE 21 128 48

BIA Range Unit Number:

HEL Status: NHEL: no agricultural commodity planted on undetermined fields

Wetland Status: Tract contains a wetland or farmed wetland

WL Violations: None

Farmland	Cropland	DCP Cropland	WBP	WRP/EWP	CRP Cropland	GRP
158.91	155.6	155.6	0.0	0.0	0.0	0.0
State Conservation	Other Conservation	Effective DCP Cropland	Double Cropped	MPL/FPW	Native Sod	
0.0	0.0	155.6	0.0	0.0	0.0	

Crop	Base Acreage	CTAP Tran Yield	PLC Yield	CCC-505 CRP Reduction
CORN	74.92		158	0.0
SOYBEANS	70.99		45	0.0
Total Base Acres:	145.91			

Owners: TILLIE SCHARNBERG

Other Producers:

CURTIS BRAUN

TRACT 2

Soils Map

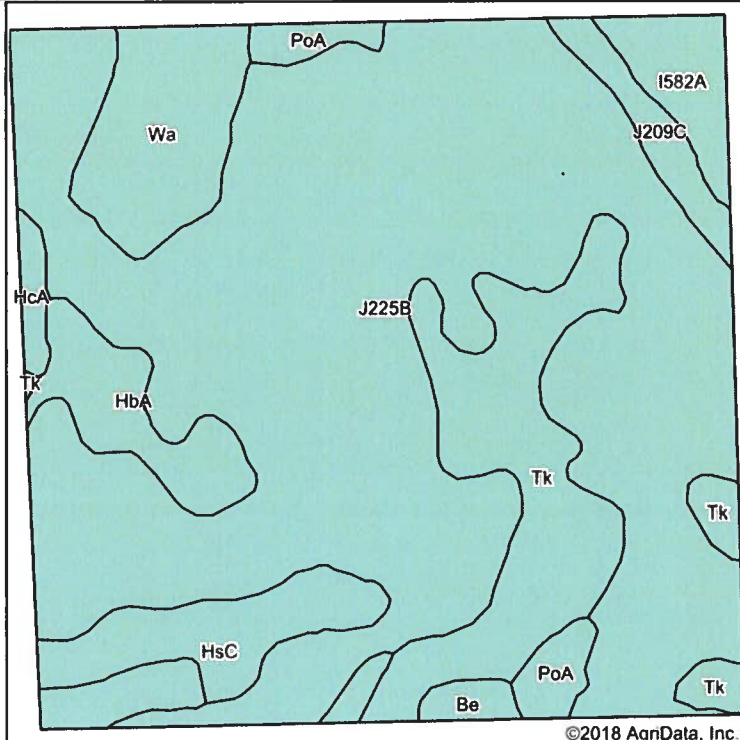

Soils data provided by USDA and NRCS.

©2018 AgriData, Inc.

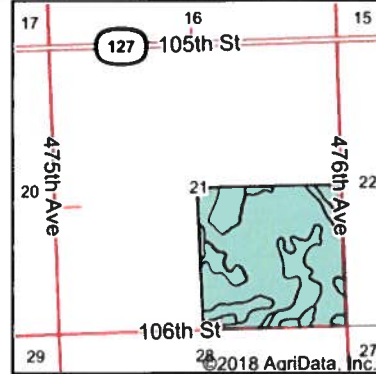

State: **South Dakota**
 County: **Roberts**
 Location: **21-128N-48W**
 Township: **White Rock**

Maps Provided By



Area Symbol: SD109, Soil Area Version: 18

Code	Soil Description	Acres	Percent of field	Non-Irr Class *c	Productivity Index	Corn	Soybeans
J225B	Forman-Aastad complex, 1 to 4 percent slopes	102.82	64.4%	Ile	88		
Tk	Tonka silty clay loam, 0 to 1 percent slopes	18.51	11.6%	IVw	58		
Wa	Waubay silty clay loam, 0 to 2 percent slopes	9.30	5.8%	Iw	98		
HbA	Hamerly-Tonka complex, 0 to 3 percent slopes	8.57	5.4%	IIs	69	70	23
HsC	Esmond-Sisseton-Heimdal, complex, 2 to 12 percent slopes, moderately eroded	7.04	4.4%	IVe	58		
I582A	Doran loam, 0 to 2 percent slopes	4.08	2.6%	IIc	87		
J209C	Forman-Buse complex, 6 to 12 percent slopes, moderately eroded	3.14	2.0%	IIIe	65		
PoA	Poinsett-Waubay silty clay loams, 0 to 2 percent slopes	3.11	1.9%	Is	93		
Be	Bearden silty clay loam	1.83	1.1%	IIs	78	80	26
HcA	Hamerly-Vallers loams, 0 to 2 percent slopes	1.26	0.8%	IIs	71	70	22
Weighted Average					82.1	5.2	1.7

*c: Using Capabilities Class Dominant Condition Aggregation Method

Soils data provided by USDA and NRCS.

TRACT 2

Topography Map



©2018 AgriData, Inc.

map center: 45° 51' 23.05, -96° 40' 41



21-128N-48W
Roberts County
South Dakota

Maps Provided By:

CUSTOMIZED ONLINE MAPPING
© AgriData, Inc 2018 www.AgrIDataInc.com



6/1/2018

Field borders provided by Farm Service Agency as of 5/21/2008.

TRACT 2

COUNTY OF ROBERTS
 REAL ESTATE NOTICE FOR THE YEAR 2019
 SDCL 10-6-50
 ASSESSMENT LIST OF REAL PROPERTY

SISSETON SD 57262
 (605) 698-3205

TILLIE M SCHARNBERG
 11694 HWY #8
 FLOODWOOD MN 55736

The value and classification of your real estate as shown on the assessment roll is as listed.

Tn	Add	S/L	T/B	Rng	Q - S	Split	School Dist	Acr/Lot	Land	----- S T R U C T U R E S -----			AG Building Exemption	--- DISCRETIONARY ---		FULL & TRUE TOTAL
										Residential	Other	Commercial		Valuation	Exemption	
30	0	21	128	48	4	--0	54-4 AG	160.00	375,421	0	0	0	0	0	0	375,421
Record #:		7785		SE4 SEC 21-128-48 WHITE ROCK TOWNSHIP						APR: 0.821		Prop Addr: STR 21-128-48				

TOTAL ACRES/LOTS: 160.00

TOTAL VALUATION: 375,421

TRACT 2

ROBERTS COUNTY TREASURER
 411 2ND AVE E STE 1A
 SISSETON SD 57262
 (605) 698-7245

06/01/2018

Parcel Information for Bill #: 2018 - 1 - 9040

Record #: 7785

TAXPAYER: TILLIE M SCHARNBERG
 11694 HWY #8
 FLOODWOOD MN 55736

Prop Addr: STR 21-128-48

Title:

Legal: 30-WHITE ROCK TOWNSHIP
 SE4 SEC 21-128-48 WHITE ROCK TOWNSHIP

21 - 128 - 48 4 - 0

School: 54-4

Acres / Lots: 160.00

	Tax Amt.	Int Due	Adv/Cert	TOTAL DUE	Date Pd	Treas#
1st Half:	1,766.17	.00	.00	.00	02/09/2018	790
2nd Half:	1,766.17	.00		.00	02/09/2018	790
Totals:	3,532.34			.00		
				***** Interest ***** Thru: 06/01/2018		

Total Valuation:	AG	NA-Z	OO	M-OO	NA	M
	305170	0	0	0	0	0
Total Tax:	3532.34	.00	.00	.00	.00	.00

1st half paid by: TILLIE SCHARNBERG/MAIL
 2nd half paid by: TILLIE SCHARNBERG/MAIL

TRACT 2